

Courses of the River from
ye Co^r to ye Maple

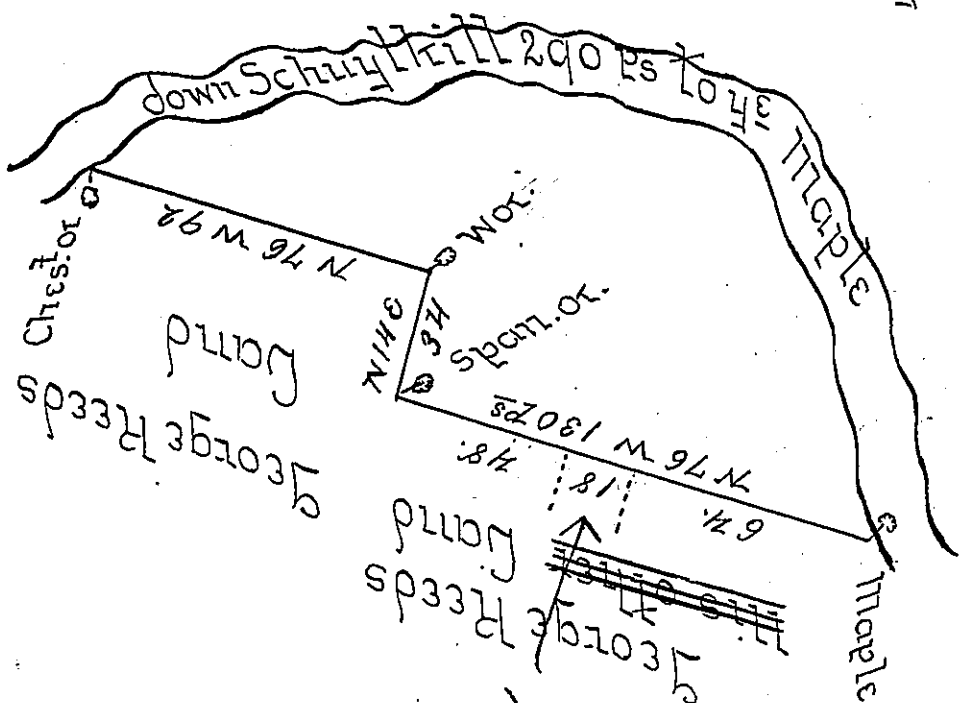

1. N. 52 E 17
2. N. 76 E 46
3. N. 55 E 24
4. N. 74 E 28
5. S. 78 E 65
6. S. 26 E 58
7. S. 8 E 36
8. S. 14 E 16.

By Virtue of a Warrant dated the 4th of March 1750.
Surveyed the 29th Day of June 1768. unto Burgon Bird
the above described Tract of Land situate over the blue
Mountains in the County of Berks. containing six-
ty nine Acres & three Quarters & Allowance of six
PCE

Jno Scull

IN TESTIMONY that the above is a copy of the original remaining on file in
the Department of Internal Affairs of Pennsylvania, made
conformably to an Act of Assembly approved the 16th day of
February, 1833, I have hereunto set my Hand and caused
the Seal of said Department to be affixed at Harrisburg,
this sixth day of JULY 1903.

Isaac P. Brown
Secretary of Internal Affairs.